

EnerRocket[®]

CONTINUOUSLY SAFEGUARDING



APPLICATIONS

- UPS Systems
- Telecommunication Systems
- Fire Alarm Safety & Security Systems
- Medical Equipment

COMPLIANCE STANDARDS

IEC 60896 PART 21 & 22
BS6290-4

TECHNICAL FEATURES



- No -Spillable Sealed Construction
- Seal Lead Acid Battery
- Absorptive Glass Mat System (AGM System)
- ABS (Acrylonitrile Butadiene Styrene) construction (FR optional)
- Gas Recombination
- Venting System for low internal pressure
- Low Self-Discharge
- Heavy-Duty, Highly Optimized Grids
- High Power Output
- Wide Operating Temperature
- Maintenance-Free Operation

CHARACTERISTICS

al Voltage	12 V	
esign Life	10 Years	
Capacity 25°C (77°F)	20 Hour rate	9.0Ah
	10 Hour rate	8.2Ah
	5 Hour rate	7.7Ah
Internal Resistance (25°C, 100% Charge)	≤ 18 mΩ	
Self Discharge (20°C)	1 Month	Remaining Capacity 97%
Operating Temperature	Discharge	-20°C - 60°C
	Charge	-10°C - 50°C
	Storage	-20°C - 60°C
Normal Operating Temperature	25°C ± 3°C	
Maximum Discharge current	135A	
Maximum Charging current	3.6A	
Short Circuit Current	450A	
Charge Methods	14.4 to 14.7V	
Constant Voltage Charge 77°F (25°C) - Cycle use	Temp. Compensation -30mV/°C	
	13.4 to 13.8V	
Charge methods	Temp. Compensation -20mV/°C	
	Constant Voltage Charge 77°F (25°C) - Standby Use	

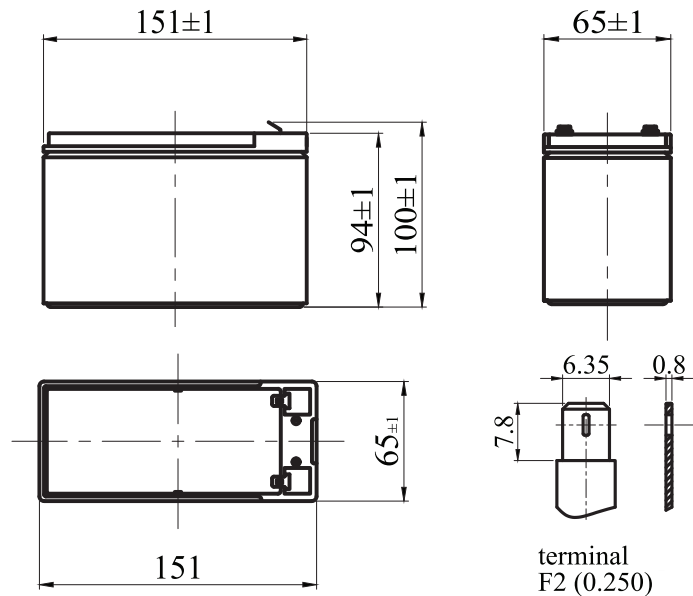

SPECIFICATIONS

Length	Width	Height	Total Height	Weight (kg)
151 mm	65	94 mm	100 mm	2.8 ±

CONSTANT CURRENT DISCHARGE (Amperes) AT 2

End Voltage Volts/Cell	5min	10min	15min	30min	1h	3h	5h	10h	20h
1.60V	33.0	24.2	17.0	9.90	5.80	2.33	1.60	0.87	0.47
1.65V	32.1	23.6	16.5	9.79	5.75	2.29	1.56	0.86	0.46
1.70V	30.9	22.9	16.1	9.36	5.71	2.25	1.55	0.84	0.46
1.75V	30.3	22.1	14.6	8.91	5.66	2.20	1.54	0.82	0.45
1.80V	29.6	21.0	13.9	8.45	5.51	2.14	1.53	0.82	0.44

CONSTANT POWER DISCHARGE (Watts) AT 25°C

End Voltage Volts/Cell	5min	10min	15min	20min	30min	1h	3h	5h	10h	20h
1.60V	71.7	44.8	33.6	25.27	19.6	11.5	4.34	3.10	1.70	0.90
1.65V	68.3	44.3	33.1	24.80	19.1	11.2	4.29	3.04	1.60	0.90
1.70V	64.8	42.9	31.1	23.56	18.5	11.0	4.20	2.98	1.60	0.90
1.75V	61.4	41.1	30.2	22.71	17.6	10.7	4.08	2.92	1.60	0.90
1.80V	58.0	39.2	28.4	21.38	16.6	10.4	3.92	2.85	1.60	0.80

